



2008-0021463

RECORDING REQUESTED BY  
AND  
WHEN RECORDED MAIL TO:

Napa County Clerk of the Board  
1195 Third Street, Suite 310  
Napa, California 94559

Recorded	REC FEE	0.00
Official Records	CCN1-NO FEE CONF	0.00
County of		
Napa		
JOHN TUTEUR		
Assessor-Recorder-Cou		
	CW	
11:28AM 22-Aug-2008	Page 1 of 6	

(Fees waived pursuant to  
Government Code §27383)

NAPA COUNTY AGREEMENT NO 715-2

Assessor Parcel Numbers: 024-080-018, 024-080-003, 024-080-022, 024-080-027, and 024-080-021 (SFAP) together with N.C.A.P. No. 024-410-011 (SFAP)

### RECORDABLE MEMORANDUM OF AGREEMENT

This Recordable Memorandum of Agreement is made and entered into as of August 19, 2008 by and between the County of Napa, a political subdivision of the State of California (hereafter "County") and Pacific Union College, a California nonprofit religious corporation (hereafter "College").

1. County and College entered into a Memorandum of Understanding (hereafter "MOU") on August 19, 2008, for the purpose of working together to complete a Master Plan Feasibility and Alternate Site Selection Study (hereafter "Study") in order to determine the feasibility of the County potentially owning and/or operating the College Airport, located on portions of five separate parcels of real property with the following Napa County Assessor Parcel Numbers: 024-080-018, 024-080-003, 024-080-022, 024-080-027, and 024-080-021 (SFAP) together with N.C.A.P. No. 024-410-011 (SFAP).
2. The term of the MOU shall commence the later of the dates when the MOU is signed by both parties or payment is made by the College to County in the sum of \$9,187.50 as set forth in Section 5(a) of the MOU. The MOU shall expire on or before the earlier of: (a) 11:59 p.m. on the last day of the 18<sup>th</sup> month following the execution of the MOU with the first month for computation purposes being the 1<sup>st</sup> day of whatever month follows the execution of the MOU; or (b) such time as County determines and notifies College in writing that it is not going to pursue purchasing and/or operating the College Airport.
3. During the term of this MOU, and the agreement (if any) for the sale of the College Airport to County, College shall maintain the College Airport as a public use airport and shall not do any of the following: (1) convert the College Airport into non-airport use; or (2) sell, lease, transfer, assign, grant a right of first refusal or option to purchase, or similarly encumber the College Airport. Leasing portions of the airport for use as airport hangars or similar airport related uses or mortgaging the College Airport shall not be deemed a violation of this provision.

4. During the term of the MOU, College shall not enter into an agreement for the sale, lease or transfer of any interest in the College Airport if such sale, lease or transfer of interest would result in the conversion of the College Airport to a non-airport use. College covenants that during the term of the MOU (including any extension thereof) it will make known to any person or entity that expresses an interest in acquiring the College Airport and/or the Subject Property, or portions thereof, that the College Airport is currently under study for acquisition by County.
5. The College Airport which is the subject of the MOU is described in Exhibit "A" attached hereto.

IN WITNESS WHEREOF, the parties have executed this Memorandum of Agreement as of the day and year first above written.

COUNTY OF NAPA, a political subdivision of the State of California

ATTEST: GLADYS I. COIL,  
Clerk of the Board

  
Gladys I. Coil

By:

  
BRAD WAGENKNECHT  
Chair, Board of Supervisors

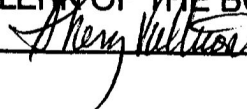
APPROVED 8-19-08  
BOARD OF SUPERVISORS  
COUNTY OF NAPA  
GLADYS I. COIL  
CLERK OF THE BOARD  
BY  Deputy

PACIFIC UNION COLLEGE

By:

  
JOHN COLLINS  
Vice President for Financial Administration

APPROVED AS TO FORM:  
ROBERT WESTMEYER,  
Napa County Counsel

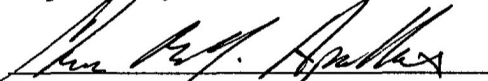
  
By: Chris R. y. Apalke Deputy

APPROVED AS TO FORM:

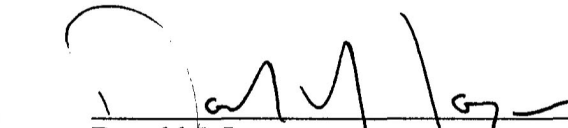
  
Donald J. Logan  
Counsel for Pacific Union College

Date: 8/11/2008

Date: August 8, 2008

**CALIFORNIA ALL-PURPOSE ACKNOWLEDGMENT**

State of California

County of

Napa

On Aug. 19, 2008

Date

before me,

Lupe Ramirez Peterkin

Here Insert Name and Title of the Officer

personally appeared

Brad Wagenknecht

Name(s) of Signer(s)

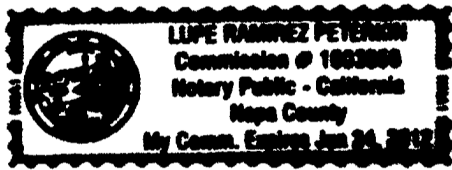

Lupe Ramirez Peterkin  
Napa County-California  
Commission # 1803859  
My Comm. Expires June 24, 2012  
707-253-4421

Place Notary Seal Above

who proved to me on the basis of satisfactory evidence to be the person(s) whose name(s) ~~is~~ are subscribed to the within instrument and acknowledged to me that ~~he~~she/they executed the same in ~~his~~her/their authorized capacity(ies), and that by his/her/their signature(s) on the instrument the person(s), or the entity upon behalf of which the person(s) acted, executed the instrument.

I certify under PENALTY OF PERJURY under the laws of the State of California that the foregoing paragraph is true and correct.

WITNESS my hand and official seal.

Signature

Lupe Ramirez Peterkin

Signature of Notary Public

**OPTIONAL**

*Though the information below is not required by law, it may prove valuable to persons relying on the document and could prevent fraudulent removal and reattachment of this form to another document.*

**Description of Attached Document**

Title or Type of Document: \_\_\_\_\_

Document Date: \_\_\_\_\_ Number of Pages: \_\_\_\_\_

Signer(s) Other Than Named Above: \_\_\_\_\_

**Capacity(ies) Claimed by Signer(s)**

Signer's Name: \_\_\_\_\_

- Individual
- Corporate Officer — Title(s): \_\_\_\_\_
- Partner —  Limited  General
- Attorney in Fact
- Trustee
- Guardian or Conservator
- Other: \_\_\_\_\_

RIGHT THUMBPRINT OF SIGNER

Top of thumb here

Signer Is Representing: \_\_\_\_\_

Signer's Name: \_\_\_\_\_

- Individual
- Corporate Officer — Title(s): \_\_\_\_\_
- Partner —  Limited  General
- Attorney in Fact
- Trustee
- Guardian or Conservator
- Other: \_\_\_\_\_

RIGHT THUMBPRINT OF SIGNER

Top of thumb here

Signer Is Representing: \_\_\_\_\_

State of California )

County of Napa )

On August 8, 2008, before me, Leticia Hamill,  
 personally appeared JOHN COLLINS and DONALD J. LOGAN, who proved to me on the basis  
 of satisfactory evidence to be the person(s) whose name(s) is/are subscribed to the within  
 instrument and acknowledged to me that he/she/they executed the same in his/her/their  
 authorized capacity(ies), and that by his/her/their signature(s) on the instrument the person(s), or  
 the entity upon behalf of which the person(s) acted, executed the instrument.

I certify under PENALTY OF PERJURY under the laws of the State of California that the foregoing paragraph is true and correct.

WITNESS my hand and official seal.

Signature Leticia Hamill



State of California )

County of \_\_\_\_\_ )

On \_\_\_\_\_ before me,  
 \_\_\_\_\_, personally appeared  
 \_\_\_\_\_, who proved to me on the basis of satisfactory  
 evidence to be the person(s) whose name(s) is/are subscribed to the within instrument and  
 acknowledged to me that he/she/they executed the same in his/her/their authorized capacity(ies),  
 and that by his/her/their signature(s) on the instrument the person(s), or the entity upon behalf of  
 which the person(s) acted, executed the instrument.

I certify under PENALTY OF PERJURY under the laws of the State of California that the foregoing paragraph is true and correct.

WITNESS my hand and official seal.

Signature \_\_\_\_\_ (Seal)



NOT TO SCALE

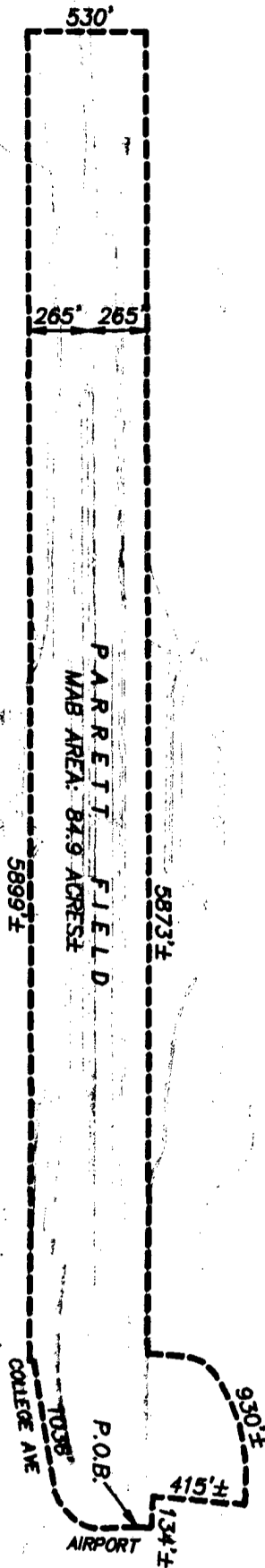

**LEGEND**

--- MINIMUM AIRPORT BOUNDARY (MAB)

--- ASSESSORS PARCEL LINES (APPROXIMATE)



**NAPA COUNTY DEPARTMENT OF PUBLIC WORKS**  
 7100 TRINO STREET • ROOM 201 • NAPA, CALIFORNIA 94950-3002  
 PHONE 707-252-4281 • FAX 707-252-4827  
**ROBERT J. PETERSON**  
 Director of Public Works  
 County Surveyor - County Engineer

**NOTE**

THIS PLAT IS NOT A SURVEY. IT IS FURNISHED IN ORDER TO APPROPRIATELY LOCATE THE AIRPORT BOUNDARY IN RELATION TO ADJOINING LOTS, ROADS, STREETS, ETC. AND NOT TO GUARANTEE ANY FIXED DIMENSIONS, BEARINGS OR SETBACKS. TOPOGRAPHIC UNDERLAY COURTESY OF PACIFIC UNION COLLEGE.

**PLAT OF DESCRIPTION**  
 OF THE  
**PARETT FIELD - ANGMN AIRPORT**  
**MINIMUM AIRPORT BOUNDARY (MAB)**  
 ANGMN, NAPA COUNTY, CALIFORNIA

JUNE, 2008  
 SHT. 1 OF 1  
 ANGMN AIRPORT/DWG

# END OF DOCUMENT

## LEGAL DESCRIPTION

### PARRETT FIELD – ANGWIN AIRPORT MINIMUM AIRPORT BOUNDARY (MAB)

A portion of Napa County Assessors Parcel Numbers 024-080-027, 024-080-021, 024-080-022, 024-080-003 and 024-080-018, all being the lands of the Pacific Union College Association; more particularly described as follows:

BEGINNING at the intersection of the northerly travelled way of Airport Way and an existing fence, labeled as "P.O.B." on the plat entitled "Plat of Description of the Parrett Field – Angwin Airport Minimum Airport Boundary (MAB) attached hereto and made a part hereof by reference; thence westerly and northerly along said travelled way of Airport Way and College Avenue 1,036 feet more or less; thence westerly 14 feet more or less to a point 265 feet westerly of the centerline of the Parrett Field runway; thence northerly along a line parallel to and 265 feet westerly of said runway centerline 5,899 feet, more or less; thence easterly 530 feet to a point 265 feet easterly of the centerline of the Parrett Field runway; thence southerly along a line parallel to and 265 feet easterly of said runway centerline 5,873 feet, more or less; thence easterly and southerly along a line as shown on the aforementioned Plat of Description 930 feet, more or less to the intersection with the extended line of an existing fence; thence westerly along said fence 415 feet more or less to an angle point thereon; thence southerly along said fence 134 feet more or less to the intersection of the extended northerly travelled way of Airport Way; thence westerly along said northerly travelled way 56 feet more or less to the POINT OF BEGINNING.

Containing 84.9 Acres, more or less

This description is for exhibit purposes only and not intended to transfer title.